

# PLXR2139 – KLXR2139

PORTAVALIGIE LATERALE SPECIFICO – SPECIFIC TUBULAR SIDE-CASE HOLDER – PORTE-VALISES LATÉRAUX SPÉCIFIQUE  
 SPEZIFISCHES STAHLROHR-SEITENTRAEGER – PORTA MALETAS LATERALES ESPECÍFICO – TRONCO LADO ESPECÍFICO  
**YAMAHA TRACER 900(2018)/ TRACER 900 GT(2018)**

| N° | Descrizione   | Caratteristiche                                | Codice                     | Quantità                                    |
|----|---|--|----------------------------|---|
| 1  | Telaio laterale - Side frame - Châssis latéral -<br>Soporte lateral - Seitenrahmen - Suporte lateral                                    | -  | PLXR2139DXS<br>PLXR2139SXS | 2 (Right;Left)                              |
| 2  | Supporto inferiore - Lower support - Support inférieur -<br>Soporte inferior - Untere Halterung - Suporte inferior                      | -  | GL3889DXV<br>GL3889SXV     | 2 (Right;Left)                              |
| 3  | Ponte - Bridge - Pont<br>Brücke - Puente - Ponte  | -  | GNB2139V                   | 1   |
| 4  | Piastrina di Supporto - Support plate - Plaque de support<br>Trägerplatte - Pletina de soporte - Placa de apoio                         | -  | GNB541                     | 2   |
| 5  | Boccola - Mounting bush - Entretoise de montage<br>Cilindro de fijación - Montagehülse - Bucha de fixação                               | -  | Z2379                      | 2   |
| 6  | Vite - Screw<br>Vis - Schraube<br>Tornillo - Parafuso   | TECF M8x20                                     | 820TECF                    | 2   |
| 7  | Vite - Screw<br>Vis - Schraube<br>Tornillo - Parafuso   | TECF M8x30                                     | 830TECF                    | 2   |
| 8  | Vite - Screw<br>Vis - Schraube<br>Tornillo - Parafuso   | TBEI M8x20                                     | 820TBEI                    | 2   |
| 9  | Vite - Screw<br>Vis - Schraube<br>Tornillo - Parafuso   | TBEI M8x25                                     | 825TBEI                    | 2   |
| 10 | Rondella spaccata - Split washer<br>Scheibe - Rondelle fendue<br>Arandela seccionada - Arruela Dentada                                  | Ø8   | Z1060                      | 2   |
| 11 | Distanziale - Spacer<br>Entretoise - Distanzstueck<br>Distanciador - Espaçador  | Ø14x8 Foro 8,5mm                               | C14L8F8,5T                 | 2   |
| 12 | Dado - Bolt - Erou<br>Mutter - Tuerca - Porca   | Dado Autobloccante Flangiato<br>Alto M8 (11mm) | 8DADIAFLN                  | 2   |
| 13 | Tappo - Cap<br>Fiche - Stecker<br>Enchufe - Capa  | -  | 13COP                      | 2   |
| 14 | Protezione specifica - Specific protection<br>Protection spécifique - Spezifischer Schutz<br>Protector específico - Protetor específico | -  | Z9870DX<br>Z9870SX         | 2<br>(Front Right Side;<br>Front Left Side) |
| 15 | Protezione specifica - Specific protection<br>Protection spécifique - Spezifischer Schutz<br>Protector específico - Protetor específico | -  | Z9871DX<br>Z9871SX         | 2(Rear Right Side;<br>Rear Left Si)         |
| 16 | Chiave Per Viti A Testa Speciale - Special Key<br>Cle Speciale - Spezialschlüssel<br>Llave Para Tornillos Con Cabeza Especial           | -  | PLXRC                      | 1   |

# PLXR2139 - KLXR2139

PORTAVALIGIE LATERALE SPECIFICO - SPECIFIC TUBULAR SIDE-CASE HOLDER - PORTE-VALISES LATÉRAUX SPÉCIFIQUE

SPEZIFISCHES STAHLROHR-SEITENTRAEGER - PORTA MALETAS LATERALES ESPECÍFICO - TRONCO LADO ESPECÍFICO

## YAMAHA TRACER 900(2018)/ TRACER 900 GT(2018)

| N° | Descrizione  | Caratteristiche | Codice | Quantità |
|----|--|-----------------|--------|----------|
| 17 | Particolari Inclusi nel 2139KIT<br>Components Included In The 2139KIT<br>Pièces Inclues Dans 2139KIT<br>Die Einzelnen Teile Sind Bei 2139KIT<br>Despieces Incluidos 2139KIT<br>Componentes incluidos na base 2139KIT | -               | -      | -        |
| 18 | Particolari Inclusi nel SR2139<br>Components Included In The SR2139<br>Pièces Inclues Dans SR2139<br>Die Einzelnen Teile Sind Bei SR2139<br>Despieces Incluidos SR2139<br>Componentes incluidos na SR2139            | -               | -      | -        |

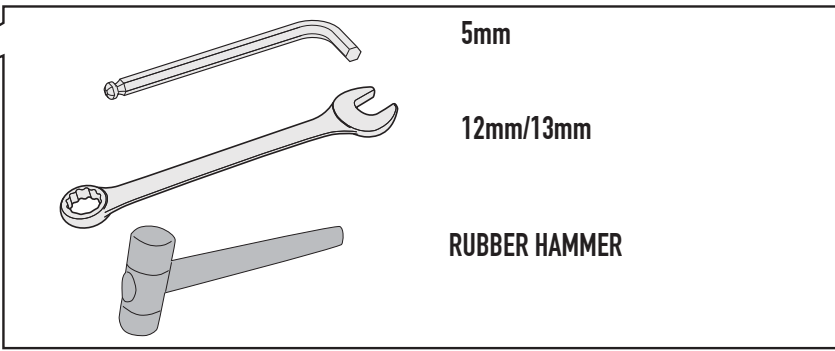
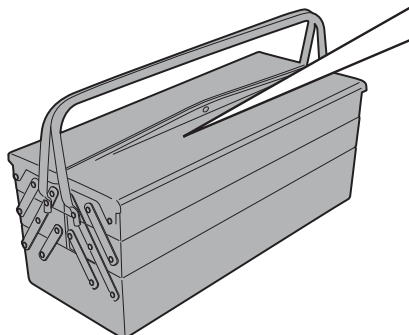
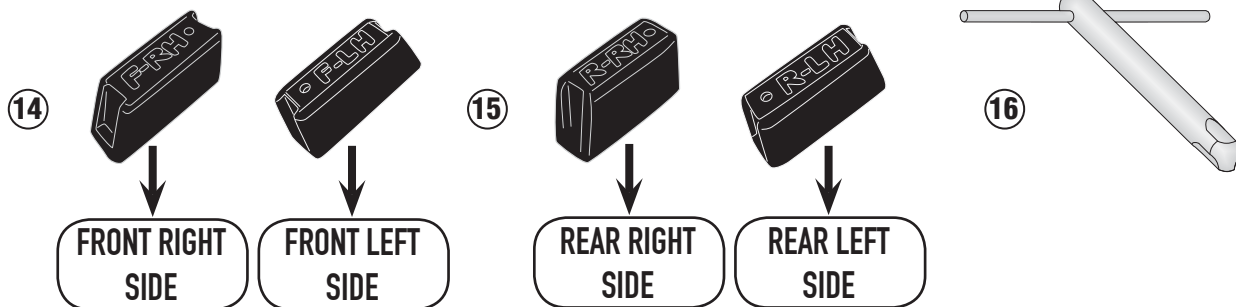
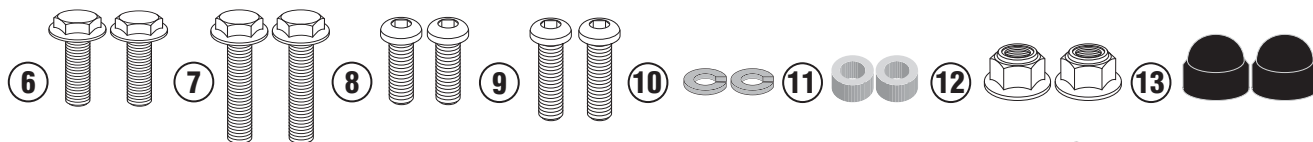
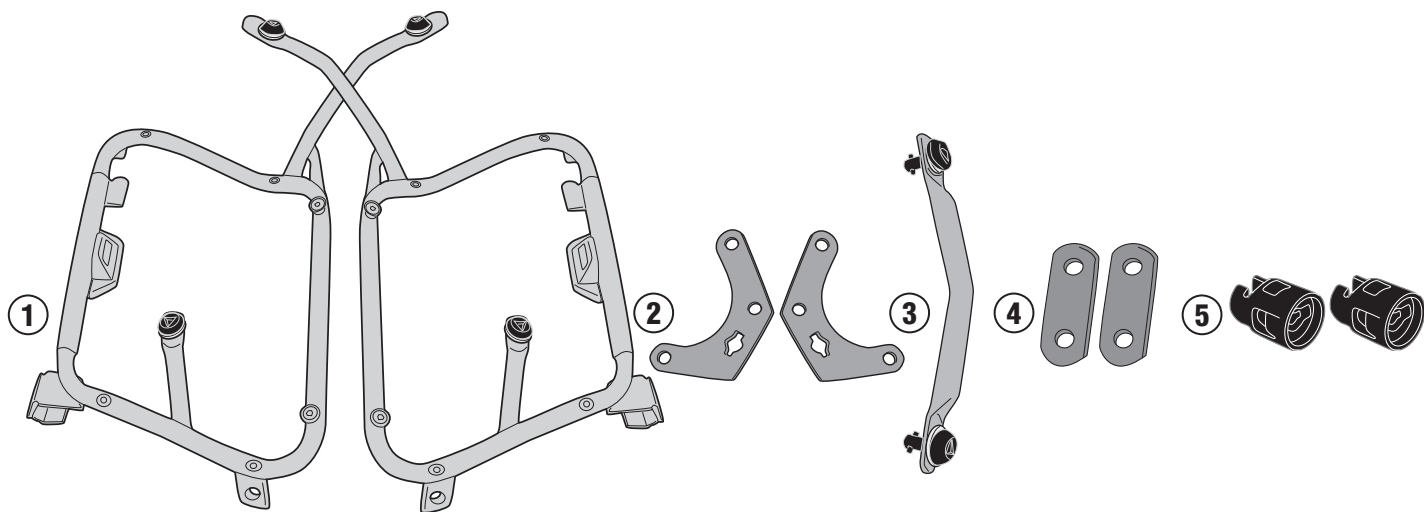

# PLXR2139 - KLXR2139

PORTAVALIGIE LATERALE SPECIFICO - SPECIFIC TUBULAR SIDE-CASE HOLDER - PORTE-VALISES LATÉRAUX SPÉCIFIQUE

SPEZIFISCHES STAHLROHR-SEITENTRAEGER - PORTA MALETAS LATERALES ESPECÍFICO - TRONCO LADO ESPECÍFICO

## YAMAHA TRACER 900(2018)/ TRACER 900 GT(2018)

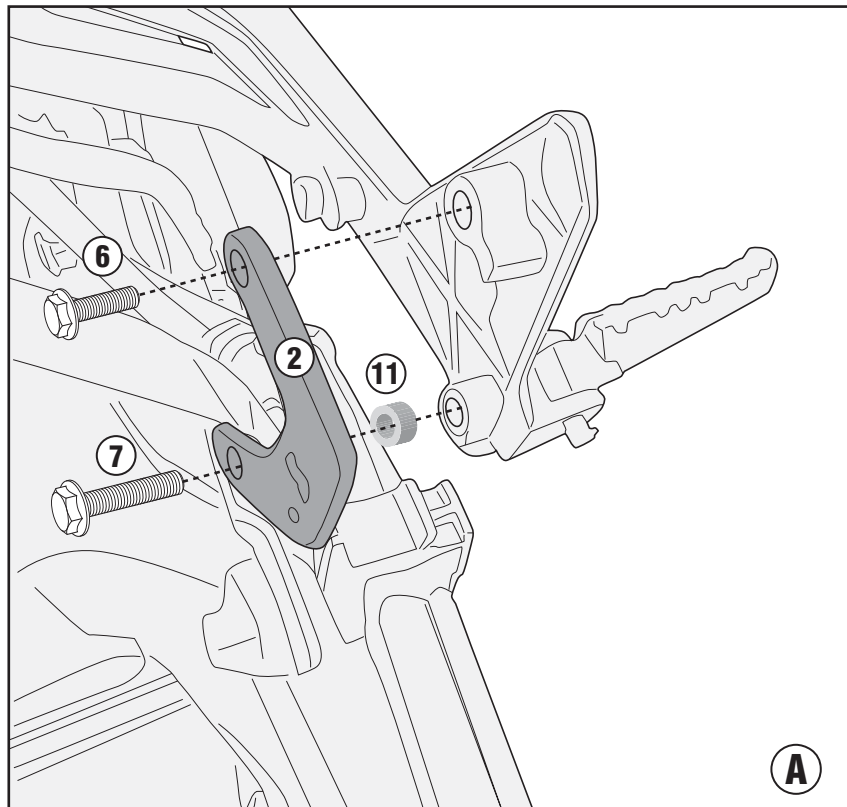
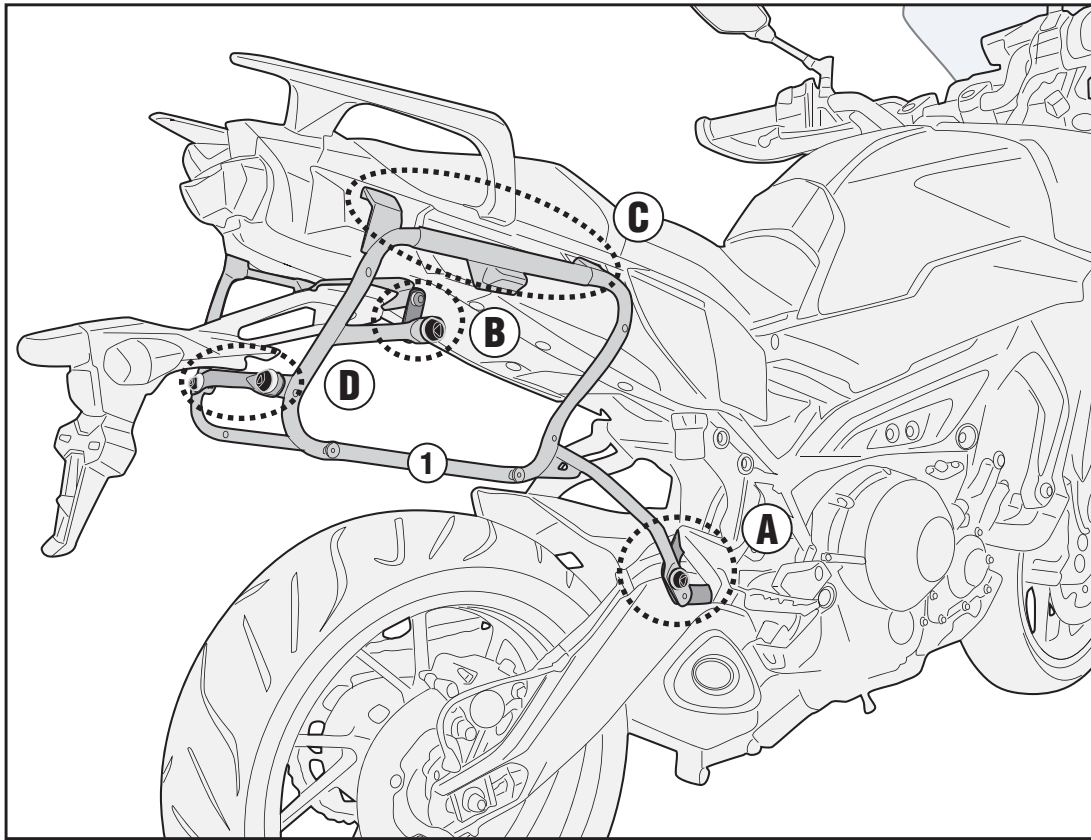

# PLXR2139 - KLXR2139

PORTAVALIGIE LATERALE SPECIFICO - SPECIFIC TUBULAR SIDE-CASE HOLDER - PORTE-VALISES LATÉRAUX SPÉCIFIQUE

SPEZIFISCHES STAHLROHR-SEITENTRAEGER - PORTA MALETAS LATERALES ESPECÍFICO - TRONCO LADO ESPECÍFICO

## YAMAHA TRACER 900(2018)/ TRACER 900 GT(2018)

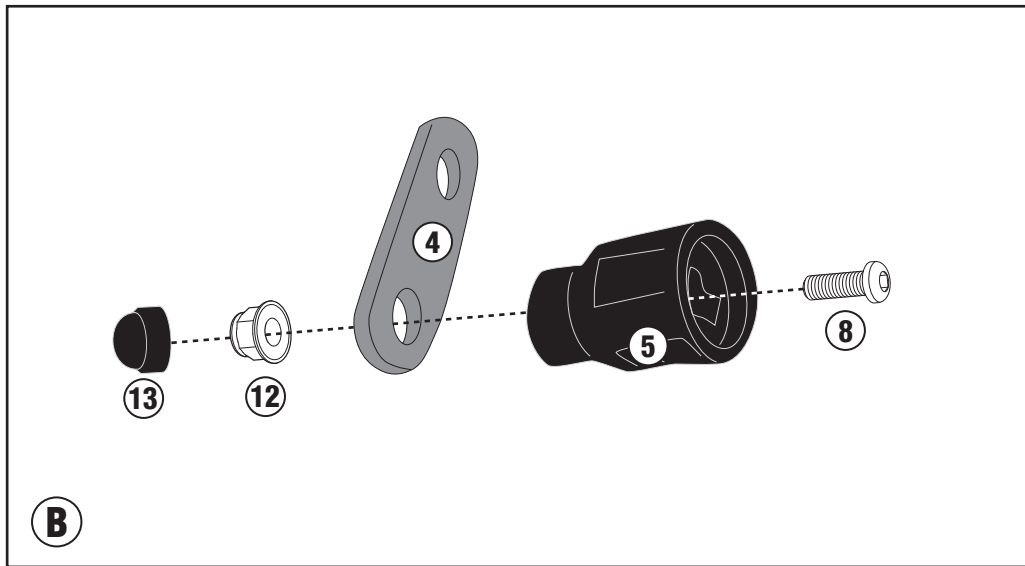

ONLY PLXR2139

SR2139+ PLXR2139

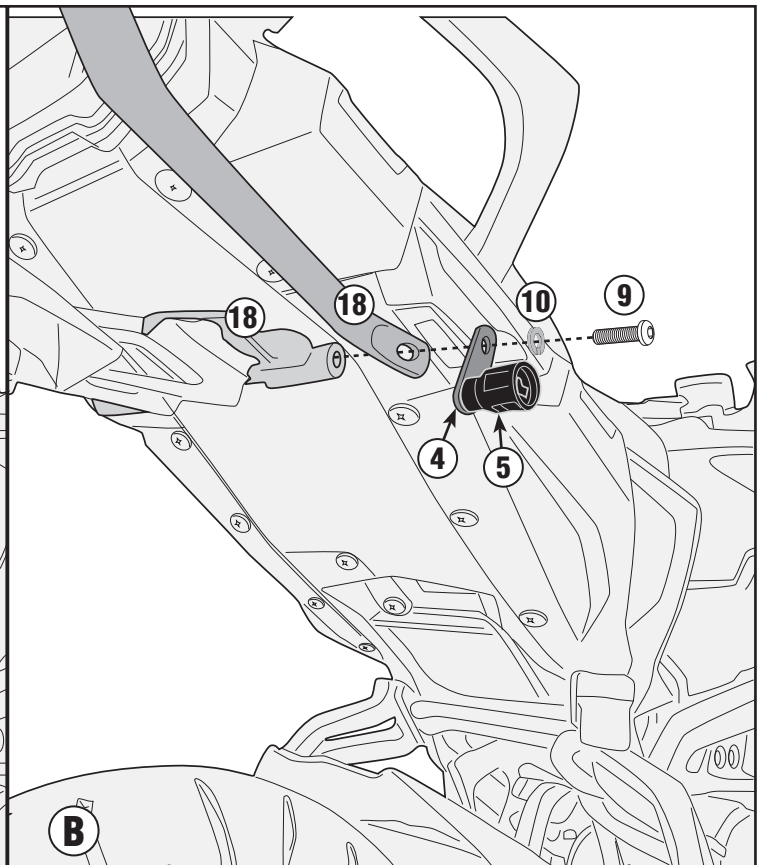
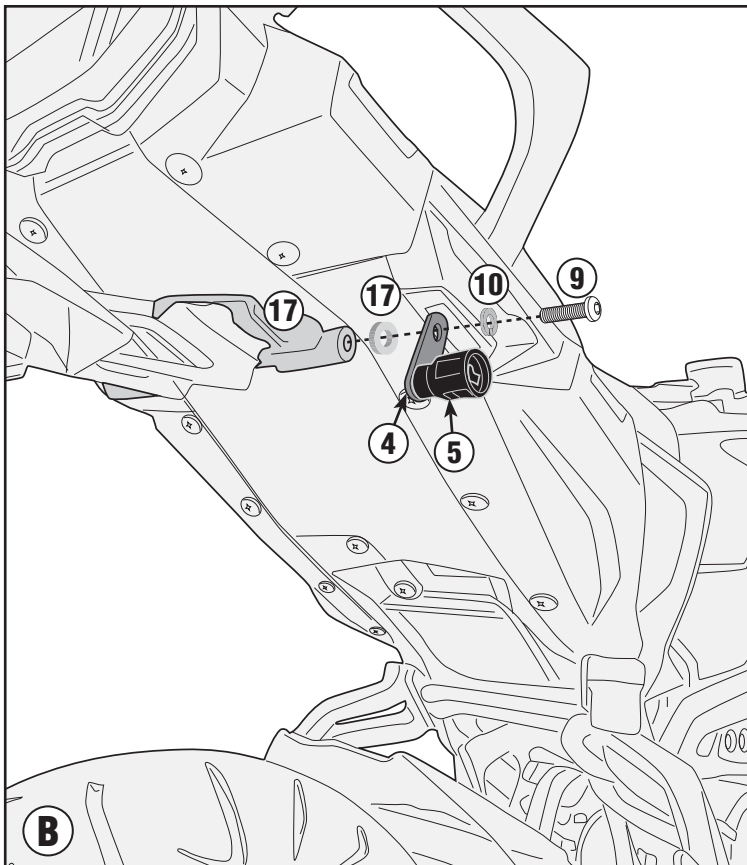

# PLXR2139 - KLXR2139

PORTAVALIGIE LATERALE SPECIFICO - SPECIFIC TUBULAR SIDE-CASE HOLDER - PORTE-VALISES LATÉRAUX SPÉCIFIQUE

SPEZIFISCHES STAHLROHR-SEITENTRAEGER - PORTA MALETAS LATERALES ESPECÍFICO - TRONCO LADO ESPECÍFICO

## YAMAHA TRACER 900(2018)/ TRACER 900 GT(2018)

### LEFT SIDE

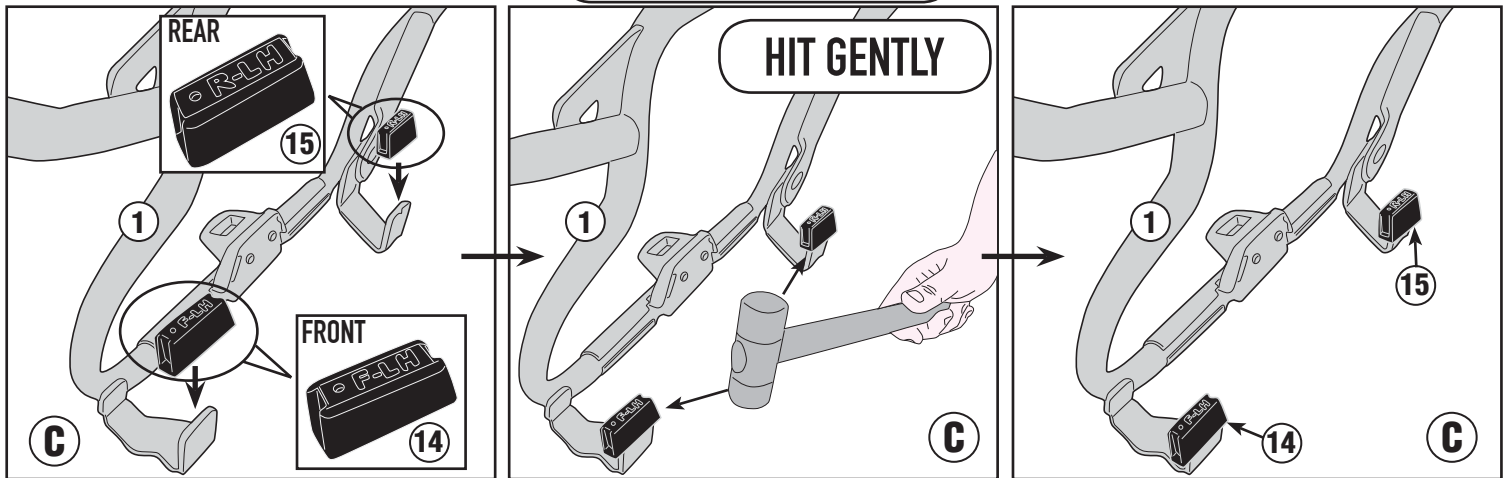

### RIGHT SIDE

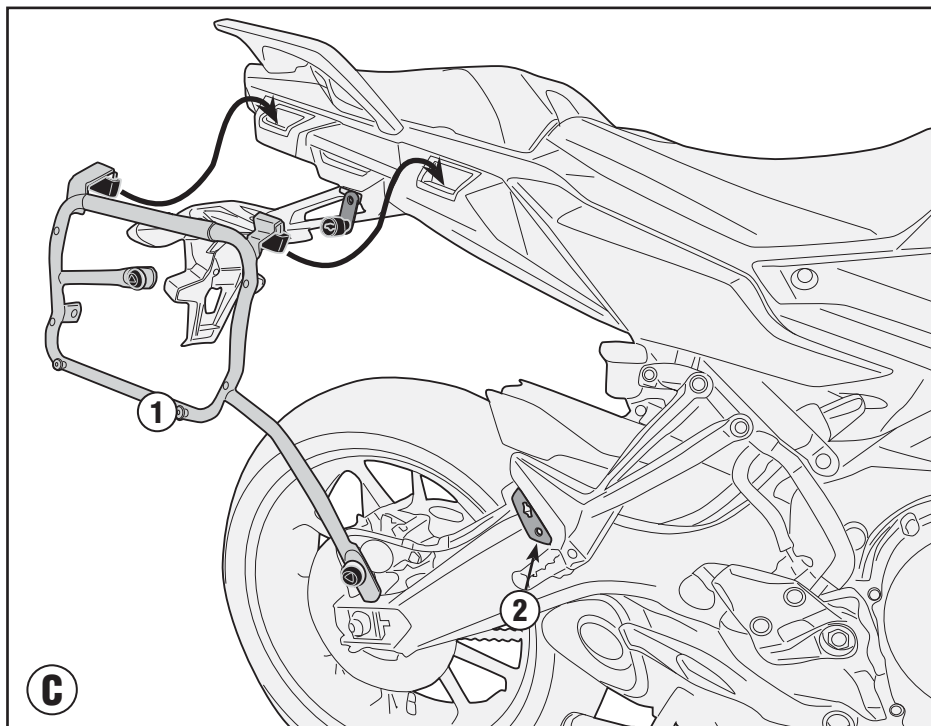
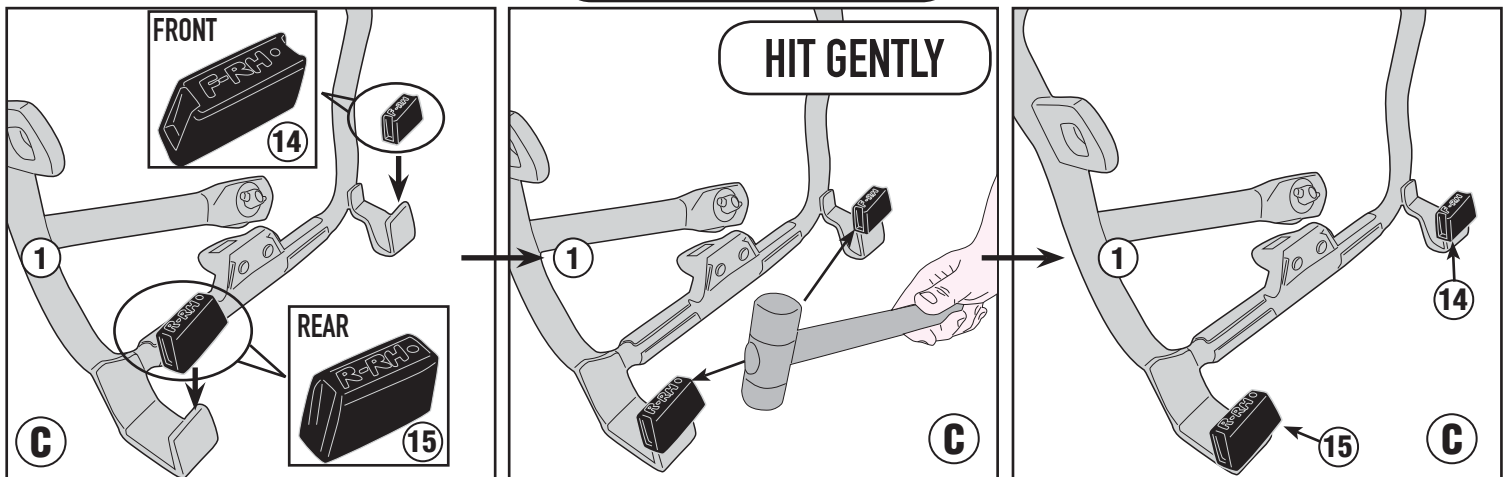

ISTRUZIONI DI MONTAGGIO - MOUNTING INSTRUCTIONS  
INSTRUCTIONS DE MONTAGE - BAUANLEITUNG  
INSTRUCCIONES DE MONTAJE - INSTRUÇÕES DE MONTAGEM

# PLXR2139 - KLXR2139

PORTAVALIGIE LATERALE SPECIFICO - SPECIFIC TUBULAR SIDE-CASE HOLDER - PORTE-VALISES LATÉRAUX SPÉCIFIQUE

SPEZIFISCHES STAHLROHR-SEITENTRAEGER - PORTA MALETAS LATERALES ESPECÍFICO - TRONCO LADO ESPECÍFICO

## YAMAHA TRACER 900(2018)/ TRACER 900 GT(2018)

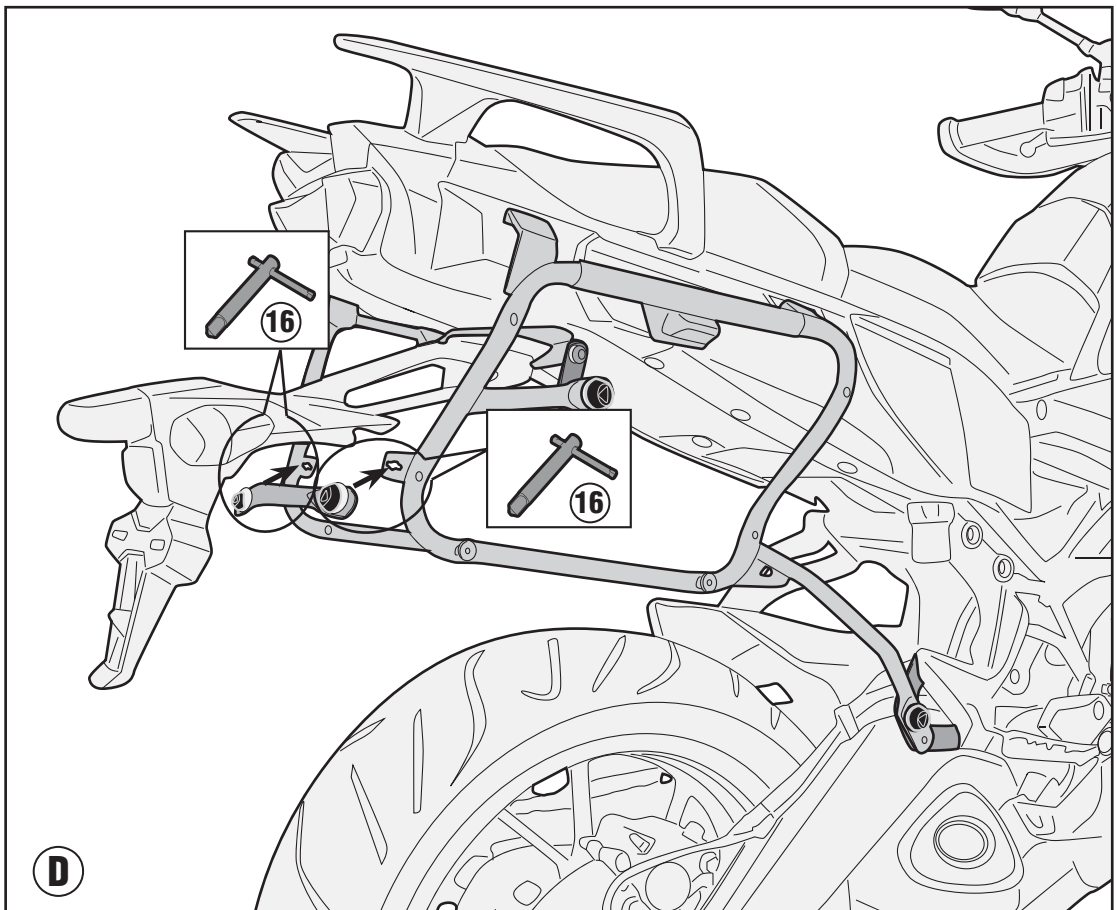
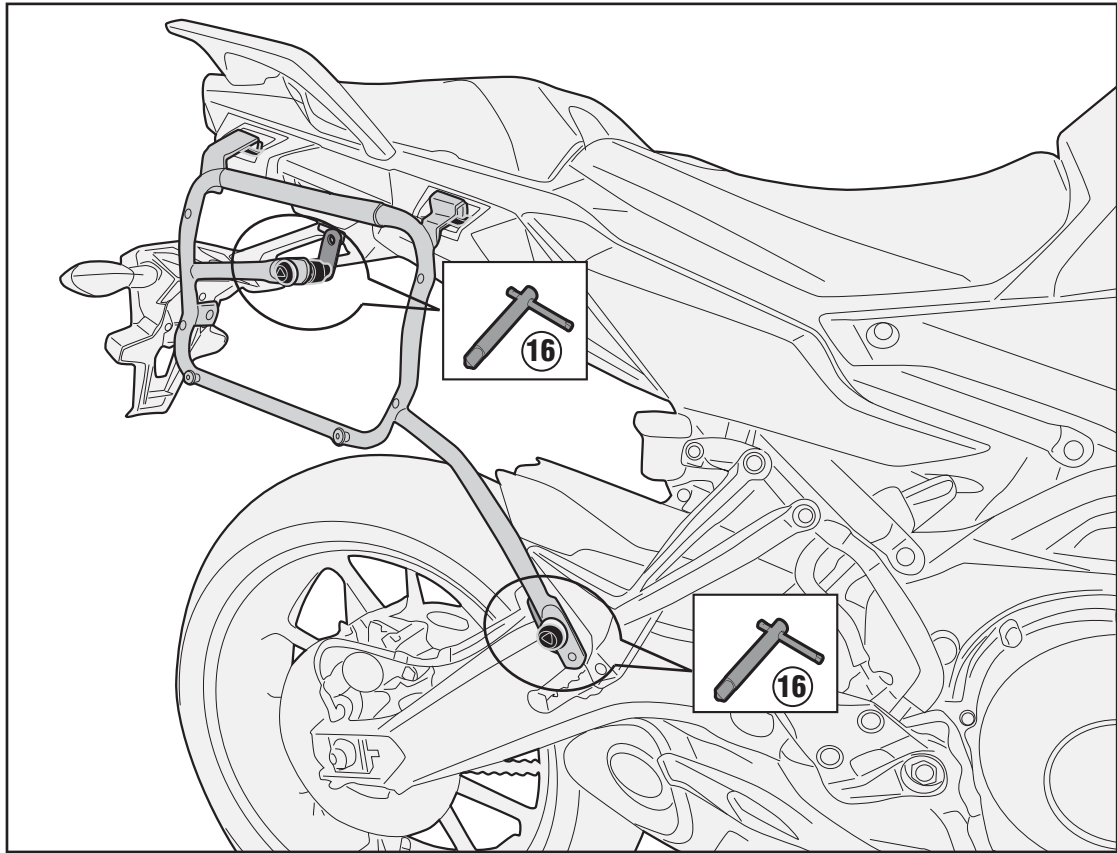

# PLXR2139 - KLXR2139

PORTAVALIGIE LATERALE SPECIFICO - SPECIFIC TUBULAR SIDE-CASE HOLDER - PORTE-VALISES LATÉRAUX SPÉCIFIQUE

SPEZIFISCHES STAHLROHR-SEITENTRAEGER - PORTA MALETAS LATERALES ESPECÍFICO - TRONCO LADO ESPECÍFICO

## YAMAHA TRACER 900(2018)/ TRACER 900 GT(2018)

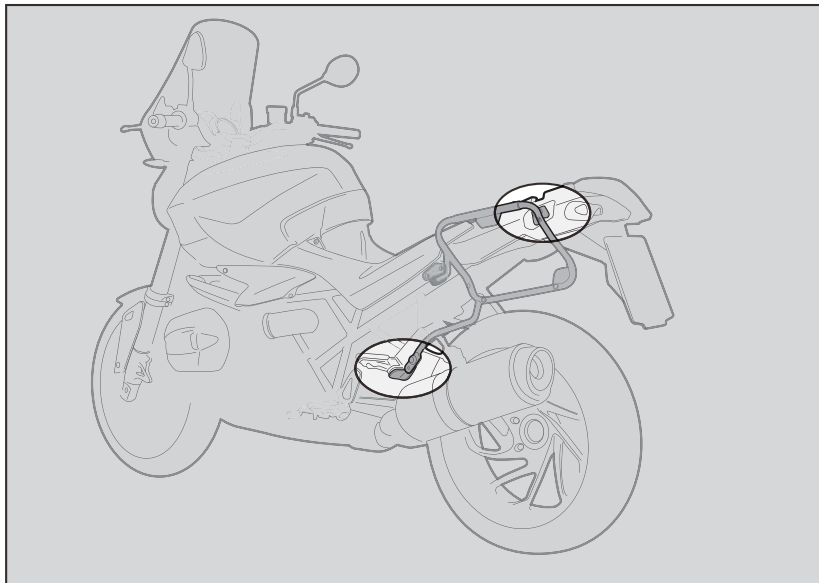

1. INSERIRE L'ATTREZZO NELLA TESTA DELLA VITE SPECIALE;
2. RUOTARE DI 1/4 DI GIRO IN SENSO ORARIO FINO A CHE LA ROTAZIONE NON TERMINA E SI AVVERTE LO SCATTO;
3. PER SMONTARE PROCEDERE IN SENSO INVERSO.

1. INSERT THE SPECIAL KEY INTO THE HEAD OF THE SCREW;
2. TURN THE KEY ¼ TURN CLOCKWISE UNTIL ROTATION STOPS AND THE SIDE CASE HOLDER IS FASTENED SECURELY TO THE FITMENT POINT;
3. IN ORDER TO DISASSEMBLE THE BRACKETRY PERFORM THE OPERATION IN REVERSE.

1. INSERER LA CLE SPECIALE DANS LA TÊTE DE LA VIS;
2. VISSER D'¼ DE TOUR DANS LE SENS HORAIRE JUSQU'AU BLOCAGE DE LA VIS POUR MONTER EN TOUTE SECURITE LE SUPPORT A SON POINT DE FIXATION;
3. POUR LE DEMONTAGE, PROCEDER EN SENSE INVERSE.

1. STECKEN SIE DAS WERKZEUG IN DEN KOPF DER SPEZIFISCHEN SCHRAUBE;
2. DREHEN SIE DIE SCHRAUBE 1 / 4 UMDREHUNG IM UHRZEIGERSINN BIS SIE BEMERKEN, DASS DIE SCHRAUBE IM BEFESTIGUNGSPUNKT EINGEKLEMMT IST;
3. FÜR DIE DEMONTAGE FOLGEN SIE DEN HINWEISE UMGEKEHRT.

1. INSERTAR LA LLAVE ESPECIAL EN LA CABEZA DEL TORNILLO
2. DAR ¼ DE VUELTA EN EL SENTIDO HORARIO HASTA QUE LLEGUE AL TOPE Y SE VEA EL TORNILLO;
3. PARA DESMONTARLO PROCEDER EN LA DIRECCIÓN CONTRARIA;

### MONTAGGIO - ASSEMBLY - MONTAGE - MONTAGE - MONTAJE

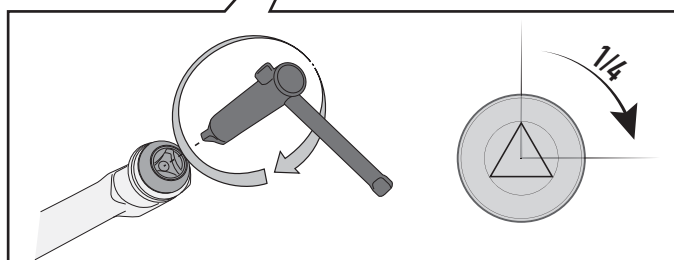
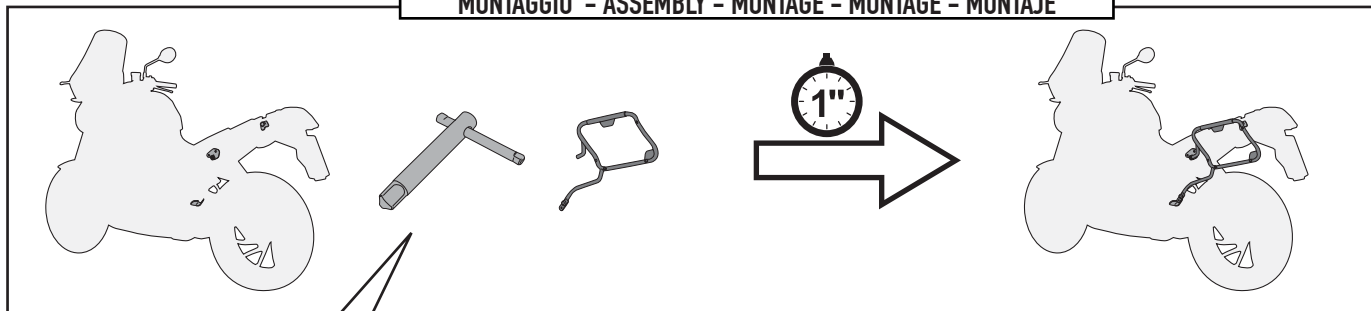

### SMONTAGGIO - DISASSEMBLY - DÉMONTAGE - DEMONTAGE - DESMONTAJE

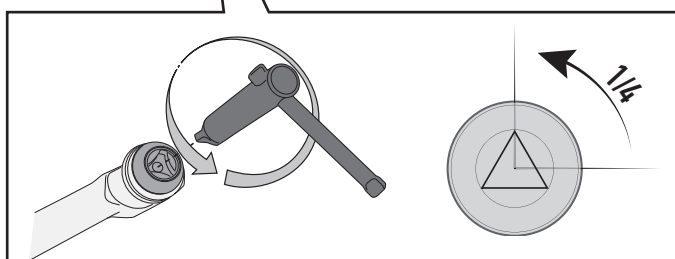
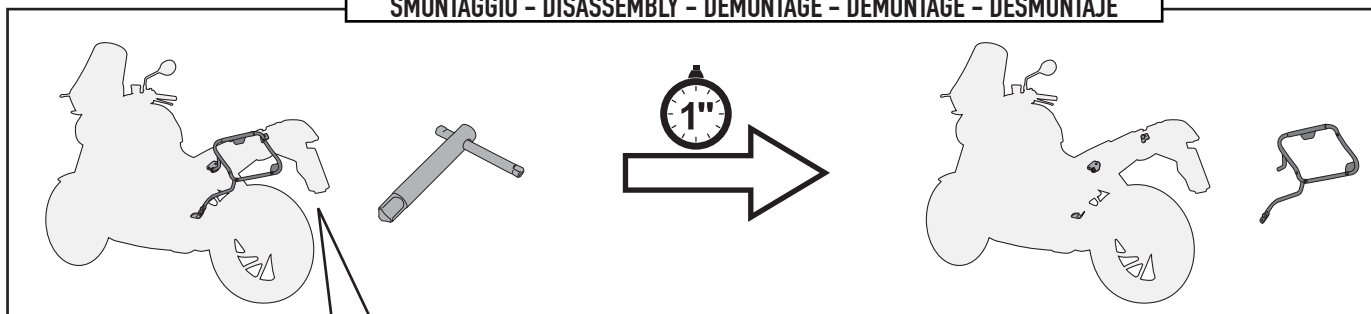

# PLXR2139 - KLXR2139

PORTAVALIGIE LATERALE SPECIFICO - SPECIFIC TUBULAR SIDE-CASE HOLDER - PORTE-VALISES LATÉRAUX SPÉCIFIQUE  
SPEZIFISCHES STAHLROHR-SEITENTRAEGER - PORTA MALETAS LATERALES ESPECÍFICO - TRONCO LADO ESPECÍFICO

## YAMAHA TRACER 900(2018)/ TRACER 900 GT(2018)

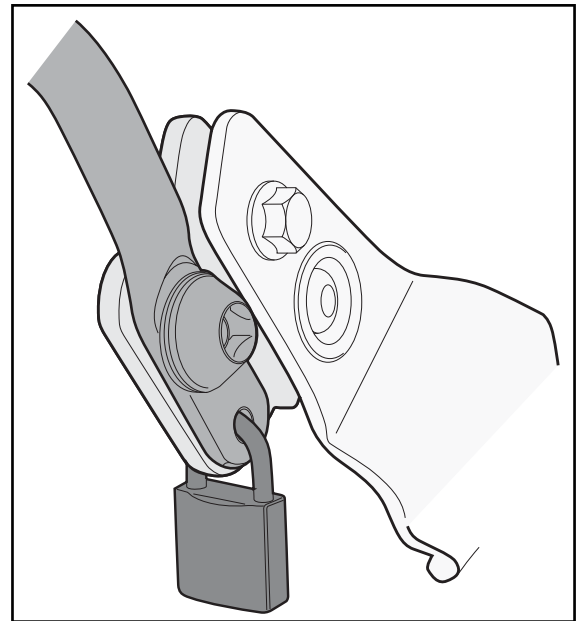
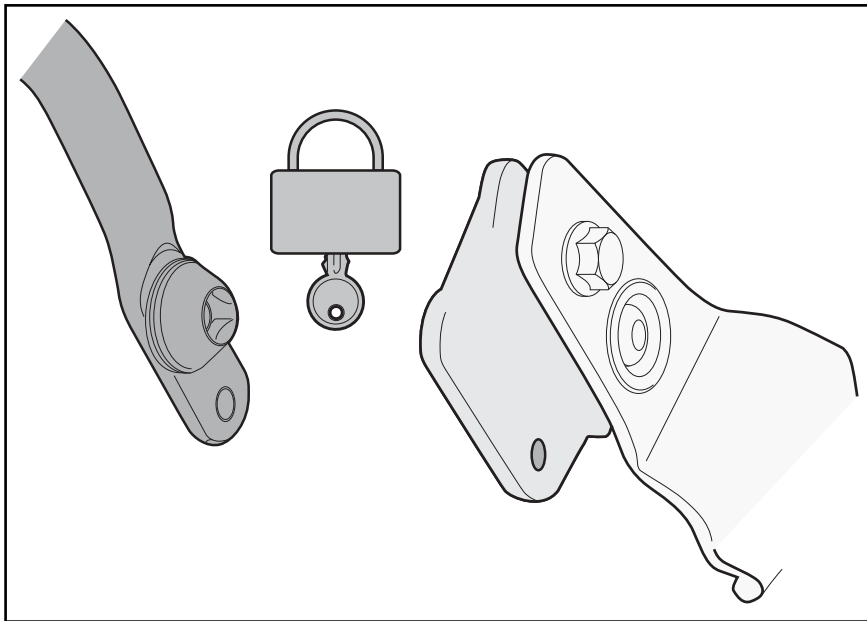
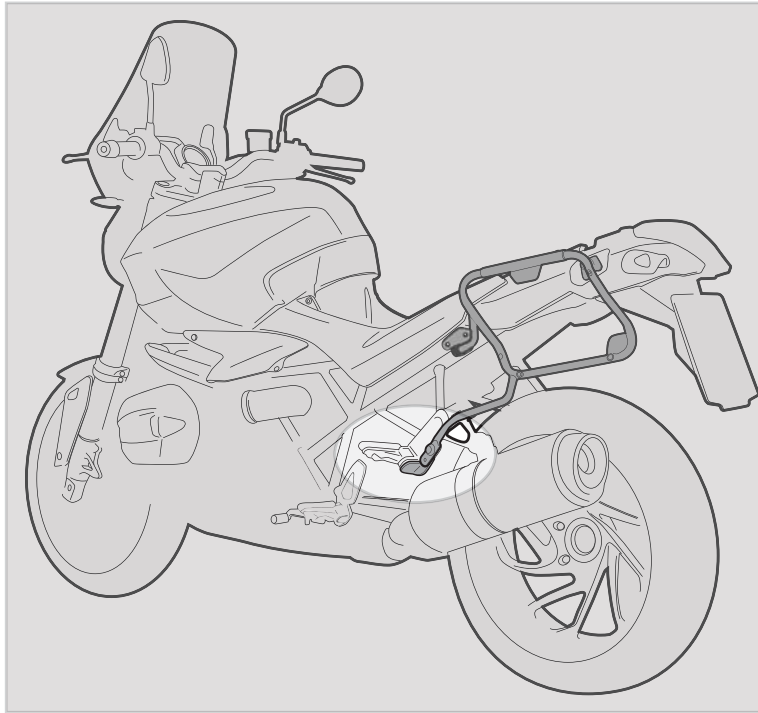

### FORO DI SICUREZZA

FORO PREDISPOSTO AD ASSICURARE IL PORTAVALIGIE LATERALE ALLA MOTO (CON UN LUCCHETTO PER ESEMPIO, NON INCLUSO).

### SECURITY HOLE

HOLE PLACEMENT IN ORDER TO INCREASE SECURITY OF THE TUBULAR SIDE-CASE HOLDER TO THE MOTORCYCLE (WITH A LOCK, FOR EXAMPLE, NOT INCLUDED).

### TROU DE SECURITE

TROU PREDISPOSE POUR ASSURER LE PORTE-VALISE LATERAL A LA MOTO (AVEC UN CADENAS PAR EXEMPLE, NON INCLUS).

### SICHERHEITSLSCH

VORGESEHENES LOCH UM DEN SEITENKOFFER TRÄGER AN DEM FAHRZEUG ZU SICHERN (Z. B. MIT EINEM VORHÄNGESCHLOSS, NICHT ENTHALTEN);

### ORIFICIO DE SEGURIDAD

ESTE ORIFICIO ESTA CREADO PARA ASEGURAR EL PORTAEQUIPAJES LATERAL A LA MOTO (POR EJEMPLO CON UN CANDADO, QUE NO ESTÁ INCLUIDO).