

PORTAVALIGIA SPECIFICO - SPECIFIC CASE HOLDER
 PORTE-VALISE SPECIFIQUE - SPEZIFISCHER KOFFER-TRÄGER
 PORTA-EQUIPAJE ESPECÍFICO

BMW K1300R 2009

ISTRUZIONI DI MONTAGGIO - MOUNTING INSTRUCTIONS
 INSTRUCTIONS DE MONTAGE - BAUANLEITUNG - INSTRUCCIONES DE MONTAJE

ATTENZIONE: PESO
 MASSIMO
 SOPPORTABILE
 6Kg.

WARNING:
 MAX. LOADING
 6Kg. (13lbs)

ATTENTION:
 CHARGE MAXIMALE
 6Kg.

ACHTUNG:
 MAXIMALE
 BELASTUNG 6Kg.

¡ATENCIÓN!: CARGA
 MÁXIMA
 AUTORIZADA 6Kg.

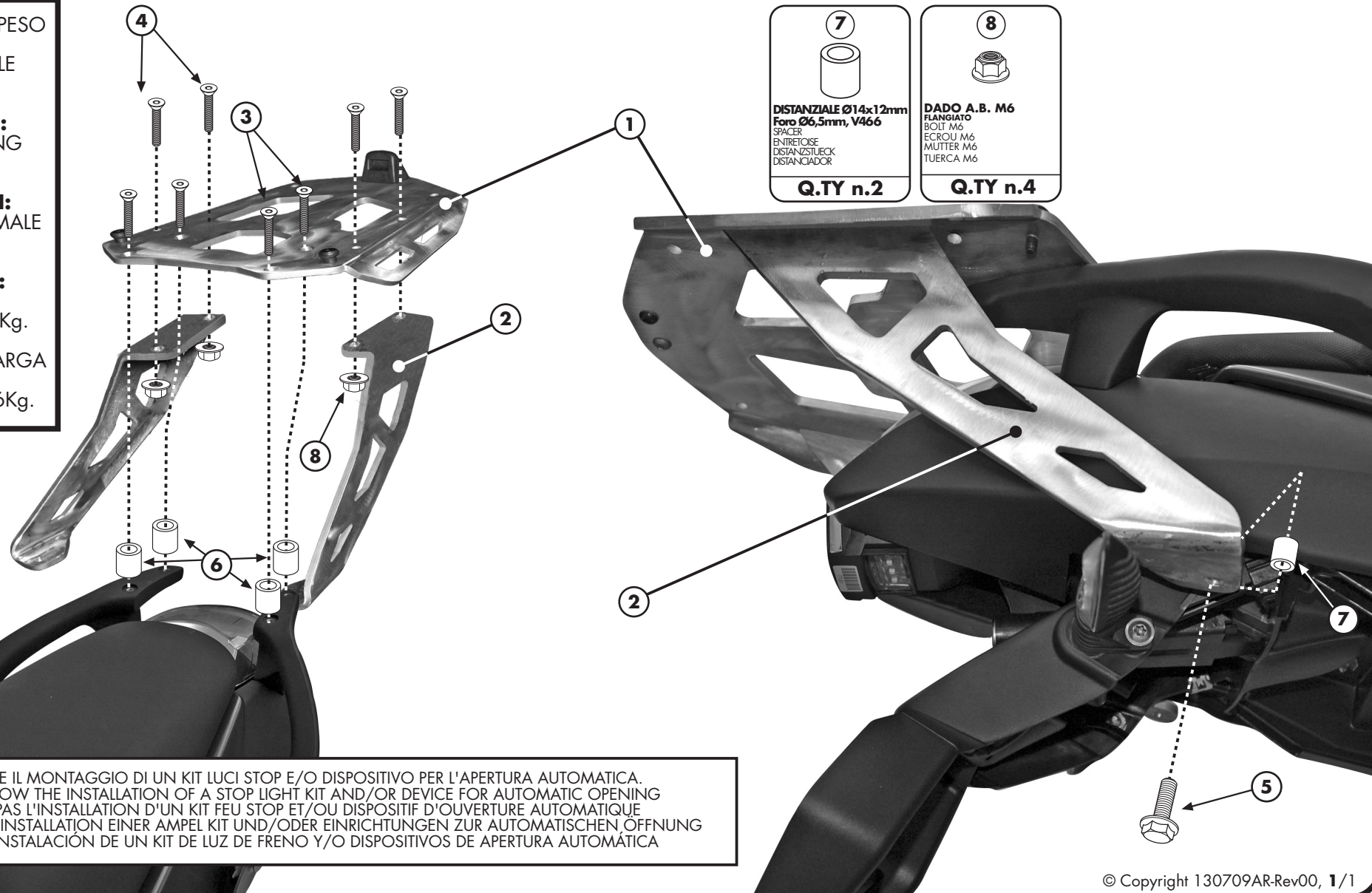
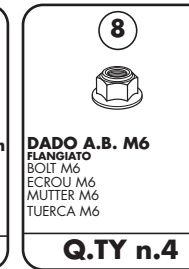
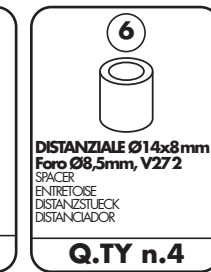
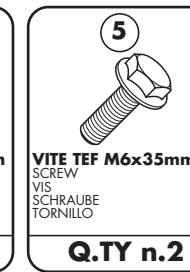
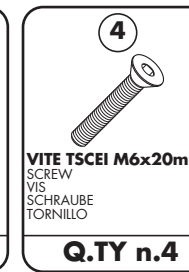
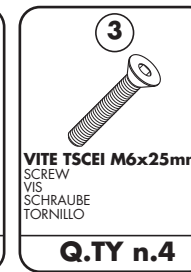

NON PERMETTE IL MONTAGGIO DI UN KIT LUCI STOP E/O DISPOSITIVO PER L'APERTURA AUTOMATICA.
 IT DOES NOT ALLOW THE INSTALLATION OF A STOP LIGHT KIT AND/OR DEVICE FOR AUTOMATIC OPENING
 IL NE PERMET PAS L'INSTALLATION D'UN KIT FEU STOP ET/OU DISPOSITIF D'OUVERTURE AUTOMATIQUE
 ES ERLAUBT NICHT DIE INSTALLATION EINER AMPEL KIT UND/ODER EINRICHTUNGEN ZUR AUTOMATISCHEN ÖFFNUNG
 NO PERMITE LA INSTALACION DE UN KIT DE LUZ DE FRENO Y/O DISPOSITIVOS DE APERTURA AUTOMÁTICA