

ATTACCHI SPECIFICI PER - SPECIFIC FITTING KIT FOR
 KIT DE MONTAGE SPECIFIQUE POUR - SPEZIFISCHER MONTAGEKIT FÜR
 ANLAJE ESPECÍFICO PARA

PIAGGIO BEVERLY 125ie - 300ie 2010

ISTRUZIONI DI MONTAGGIO - MOUNTING INSTRUCTIONS
 INSTRUCCIONES DE MONTAJE - BAUANLEITUNG - INSTRUCCIONES DE MONTAJE

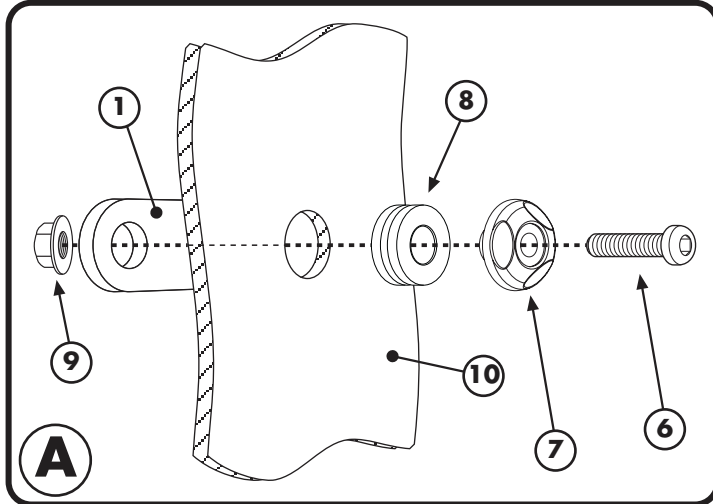

1



SUPPORTO
 SUPPORT
 SUPPORT
 HALTERUNG
 SOPORTE

Q.TY n.2(Dx-Sx)

2



VITE TE M10x55mm
 passo 1,25
 SCREW M10x30mm
 VIS M10x30mm
 SCHRAUBE M10x30mm
 TORNILLO M10x30mm

Q.TY n.2

3



DADO M10
 BOLT M10
 ECROU M10
 MUTTER M10
 TUERCA M10

Q.TY n.2

4



RONDELLA IN MOUSSE
 Z1072
 RUBBER WASHER
 RONDELLE EN CAOUTCHOUC
 GUMMI SCHEIBE
 ARANDELA DE GOMA

Q.TY n.2

5



TUBO Ø16x40mm
 SPACER
 ENTRETASSE
 DISTANZSTUECK
 DISTANCIADOR

Q.TY n.2

6



VITE TBEI M6x25mm
 SCREW
 VIS
 SCHRAUBE
 TORNILLO

Q.TY n.4

7



Z871N
BOCCOLA DI RITENZIONE VETRO
 PLASTIC BUSH
 DOUILLE PLASTIQUE
 BUCHSE PLASTIK
 CASQUILLO

Q.TY n.4

8

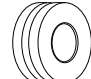

Z268
GOMMINO
 FAIRLEADER
 CHAUMARD
 GUMMI
 GOMA

Q.TY n.4

9



Z268
DADO A.B. M6
 FLANGIATO
 BOLT M6
 ECROU M6
 MUTTER M6
 TUERCA M6

Q.TY n.4

10



.

11



COMPONENTI ORIGINALI
 ORIGINAL PARTS
 PARTIES ORIGINALES
 ORIGINAL BAUTEILE
 COMPONENTES ORIGINALES

Q.TY n.-

